

Special Service Tools – Group K

KM-113-
2 Bracket

Mount for transmission
bracket.

KM-161-
B Bearing Puller

Synchroniser hub for 5th
gear inner races for
tapered roller bearing
compensation.

KM-519 Installer

Driveshaft seal to
transmission housing.

KM-523- Remover,
1 Installer

Needle bushing and roller
bushing for transmission
housing.

MKM-
557-A Puller Set

Driveshaft seals from
transmission housing.

KM-652 Flywheel
Holder

To lock flywheel when
removing or installing
clutch.

KM-113-2

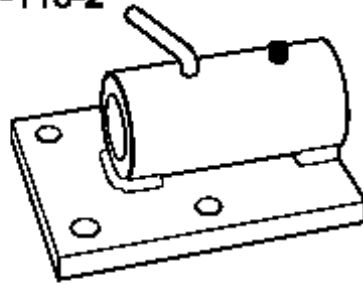

KM-161-B

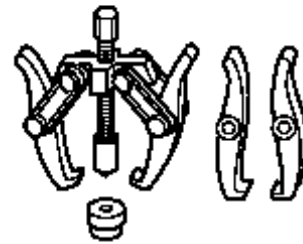

KM-519

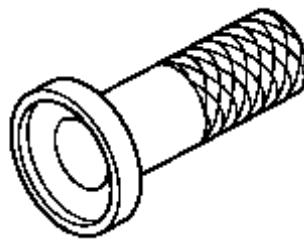

KM-523-1



MKM-557-A

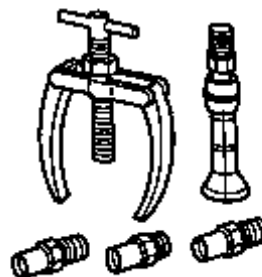

KM-652

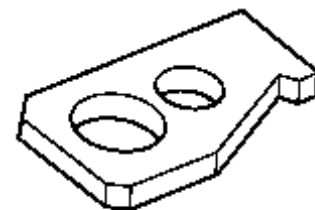

T 9484

KM-736 Centring Tool

To centre clutch disc.

MKM-
886 Transmission
Holder

To hold transmission.

KM-6042 Removal Lever

To remove shift cables
from shift guide assembly.

KM-6110 Bearing
Remover

To remove mainshaft
bearing from clutch
housing.

KM-6111 Bearing
Installer

To install mainshaft
bearing into clutch

housing, used with KM-523-1.

KM-6112 Distance Ring Installer

To install distance ring of driveshaft bearing into clutch housing, used with KM-523-1.

KM-736

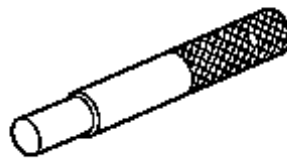

MKM-886

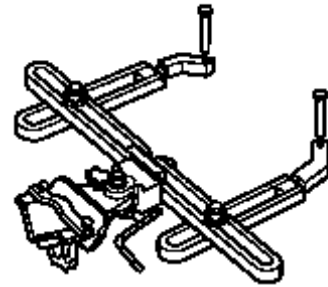

KM-6042

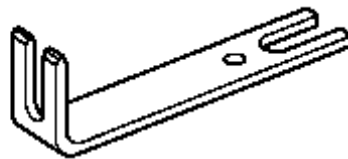

KM-6110

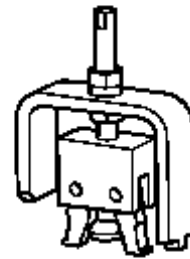

KM-6111

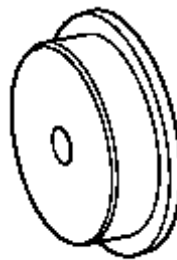

KM-6112



T 9485

KM-6113 Bearing Remover

To remove differential assembly bearings from clutch and transmission housing.

KM-6114 Bearing Installer

To install differential assembly bearings into clutch and transmission housing, used with KM-523-1.

KM-6115 Clutch Housing Holder

To hold clutch housing for transmission overhaul, used with KM-113-2.

KM-6116 Clutch Housing Remover

To remove clutch housing

from transmission and to install bearings onto drive and mainshafts/transmission housing.

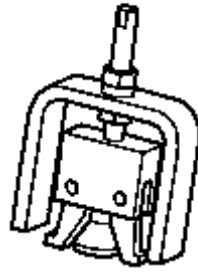
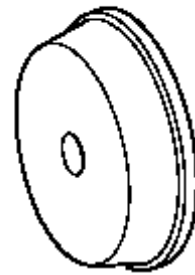
KM-6113**KM-6114**

KM-6117 Transmission Shaft Holder

To hold driveshaft when removing fixing screw of drive and mainshaft bearings.

KM-6118 Bearing Remover

To remove bearings from differential assembly, used with KM-161-4.

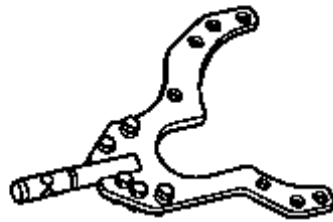
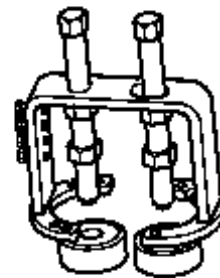
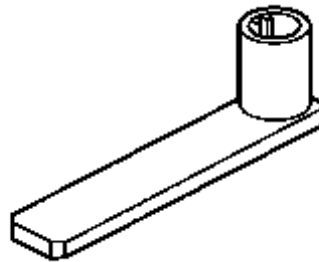
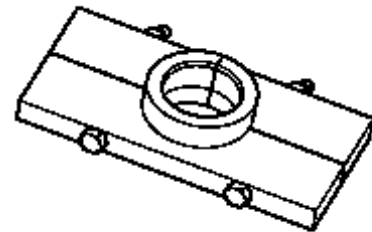
KM-6115**KM-6116****KM-6117****KM-6118**

T 9486

KM-6119 Bearing Installer

To install intermediate shaft bearing into clutch housing, used with KM-523-1.

KM-6120 Bearing Installer

To install driveshaft bearing into clutch housing used with KM-523-1.

KM-6121 Mounting Sleeve

To fix synchroniser assembly on intermediate shaft.

KM-6122 Bearing Remover

To remove mainshaft bearing from transmission

housing, used with KM-523-1.

KM-6123 Bearing
Remover

To remove driveshaft
bearing from transmission
housing, used with KM-523-1.

KM-6126 Intermediate
Shaft Remover

To remove bearing from
intermediate shaft, used
with KM-523-1.

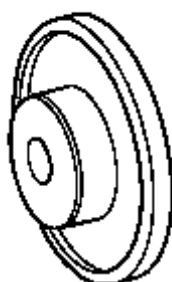
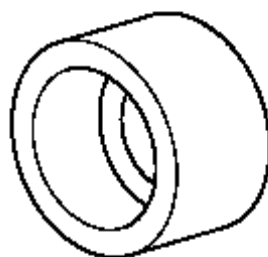
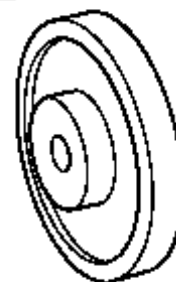
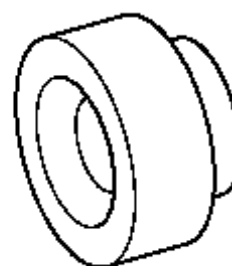
KM-6119**KM-6120****KM-6121****KM-6122****KM-6123****KM-6126****T 9487**